



US9425739 (02-10)

Operator's Manual & Parts List

425, 425L, Lesco 425, 475, Lesco 475, 435, 478, 485, 473-P, 473-D, 473-ECS including Deluxe and Heavy Duty Models

STOP!

If you are missing parts, instructions or have questions, DO NOT take this unit back to the store. Call 1-800-SOLO-INC. Solo will send the missing parts/information to you promptly.

WARRANTY:

Solo backpack sprayers are covered by Solo's 1-YEAR LIMITED WARRANTY. Solo manufactured parts which fail due to defective material or workmanship will be repaired or replaced without charge. See page 5 for full details and complete warranty information.

MAINTENANCE TIP: Cap gasket is prelubricated for improved sealing. Occasional lubrication is recommended.

SAFETY PRECAUTIONS:

1. Before using sprayer with chemicals, fill sprayer with fresh water to assure that you have it properly assembled; pressurize and practice spraying. Also, check for any leaks at this time. When thoroughly familiar with the sprayer operation, follow normal operating procedures.
2. Ensure all pressure in the sprayer is relieved by locking the shut-off valve in the open position.
3. Avoid contact with chemicals.
4. Always wear rubber gloves, safety goggles and appropriate protective clothing.
5. Work in a well ventilated area.
6. Individuals should be trained in the proper use of this sprayer, chemical handling procedures, and first aid/emergency care. Where training is not available, individuals should study and follow the procedures detailed in this manual.

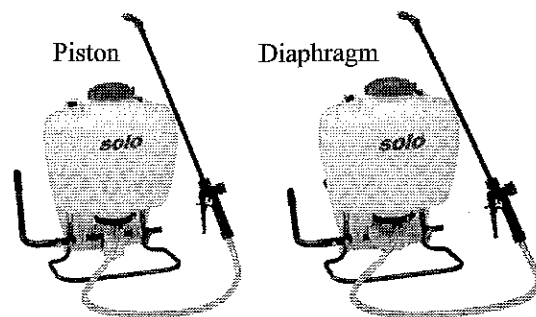

WARNING:

Chemicals can be harmful to individuals and the environment if improperly used. In addition, some chemicals are caustic, corrosive or poisonous and should be avoided. Read warnings and chemical manufacturers' instructions. Solo high density polyethylene sprayers are fitted with Viton® seals which are resistant to a wide variety of agricultural and household chemicals; however, care should be exercised to ensure that sprayer components are clean, functioning properly, and in a good state of repair before and during use. If in doubt about a particular chemical, check with the manufacturer. If you suspect or observe indications that the material may be unsafe in a Solo sprayer...STOP. DO NOT USE OR APPLY CHEMICAL. ALWAYS WEAR RUBBER GLOVES, GOGGLES, AND APPROPRIATE PROTECTIVE CLOTHING!

- Read and follow operating instructions.
- Do not fill with, use, or spray flammable materials.
- Do not modify sprayer.
- Never spray in the direction of humans, animals or property which might be injured or damaged by spray formula.
- Do not use disinfectants, solvents or impregnating agents unless first tested to ensure they are not harmful to the environment or sprayer.
- Do not use liquids with a temperature above 110°F (43°C).
- Wear appropriate protective clothing to prevent contact with chemical agents.
- Rinse and clean sprayer thoroughly after using. Disposal of contaminated rinse should be in accordance with applicable ordinances. Observe the precautionary instructions of the chemical manufacturer.
- DO NOT USE ANY ACID (INCLUDING CITRUS) OR CAUSTIC CHEMICALS (INCLUDING BLEACH).
- Remember that a sprayer with liquid is a significant amount of weight (8 lbs. per gallon). Do not climb when wearing the sprayer. Use caution when bending, leaning or walking. Bend at the knees rather than the waist.
- During sprayer operation, the pressure cylinder (#4400240) contains compressed air and liquid. Compressed air and liquid under pressure are inherently dangerous. Before making adjustments on sprayers fitted with a pressure regulating valve body (#4074323) or control knob (#4074344) located on the pressure cylinder or any other repair or inspection of any sprayer, be sure to relieve pressure through the shut-off valve and wand.

CUSTOMER SERVICE COMMITMENT FROM SOLO'S SERVICE DEPARTMENT

In the event the sprayer you have purchased has missing or damaged parts, please call 1-800-765-6462, 9:00 AM - 5:00 PM EST.

In order to assist your service representative, please have the following information available: sprayer model number, part description and part number. A parts list is included in your operator's manual.

Solo is committed to your satisfaction and is continuing its efforts to earn your future business.

Visit us on the web at www.solousa.com
Troubleshooting and parts ordering available on-line.

REMOVING PLASTIC ADJUSTABLE NOZZLE

Unscrew the nozzle cap (1) from the nozzle body (3). This is best accomplished while the retaining nut (2) is fastened tightly to the elbow (5). Next, unscrew the retaining nut (2). Push the nozzle body (3) out of the retaining nut (2). The filter with gasket (4) will come out with the body. To reinstall the nozzle, reverse the above instructions.

ASSEMBLY INSTRUCTIONS FOR WAND

1. Insert wand into shut-off valve as shown.
2. Tighten the screw cap clockwise onto the shut-off valve.

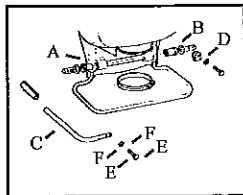
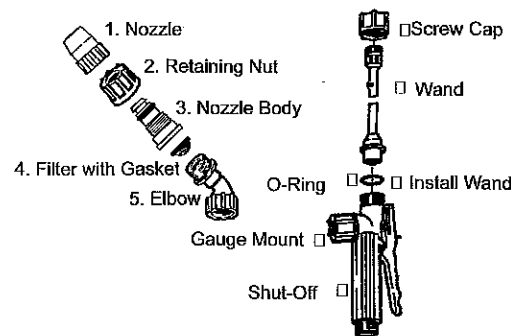

PUMP LEVER INSTALLATION: All hardware necessary for pump lever installation is included with the sprayer. The pump lever (C) should be installed as follows: place lever handle (C) onto the shaft (A). Align bolt holes and install the two bolts (E) and washers (F); then tighten. To install pump lever on the opposite side on a Diaphragm Pump sprayer, remove the stop plate (D) and washer, install the pump lever as above. The stop plate (D) should be mounted on the inner bolt hole with the closed end of the stop plate pointing downward on the opposite side of the pump shaft.

FOLD-AWAY PUMP HANDLE* INSTALLATION (FOR DELUXE MODELS ONLY):

1. Remove bolt and nut (A) from pump rod (B).
2. Slide handle assembly over the pump rod and align the holes so that the rear (elbow) portion of the handle points up and slightly forward (approximately 45 degrees) and away from the Solo logo. Reinstall bolt and locknut. Pump handle can be installed on the opposite side of the sprayer for right hand pumping. (For Diaphragm Pump Sprayer, stop plate will need to be relocated to the left side.)
3. The handle can be rotated to either down (pumping) or up (storage) positions. Note: The handle swings away from the sprayer, then up or down as desired. The spray wand attaches to the clamps on the handle assembly for storage (does not apply to the brass wand).

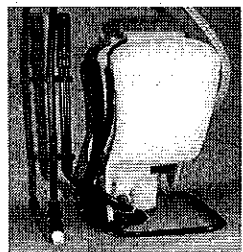
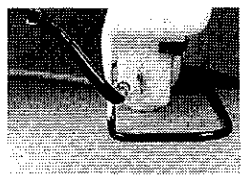
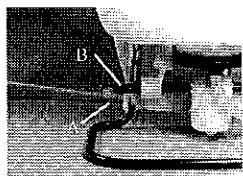

SHOULDER STRAP INSTALLATION:

The top of the shoulder straps are pre-attached to the sprayer by means of a buckle. The lower end of the straps are attached by fastening the strap hooks to the metal frame between where frame exits the plastic tank and makes a bend.

REGULATING THE PRESSURE: (FOR DELUXE MODELS ONLY)

The Solo backpack sprayer is equipped with a built-in regulator to control output pressure. This regulator is operator adjustable. Make adjustments prior to filling tank. To adjust the regulator, remove the tank cap and the filter basket. Look inside the

spray tank; you will see the top of the regulator. There are 4 fingers on the regulator knob. The finger farthest to the left is #1; to the right is #4. They are numbered 1, 2, 3, 4. 1 = 15 psi, 2 = 30 psi, 3 = 45 psi, 4 = 60 psi. The higher the pressure, the more chemical applied from the sprayer in a given amount of time, but the droplets will be smaller with more drift. If the spray pressure must be changed, excess pressure in the pressure cylinder must be released back into the tank through the spray tube. To adjust, push down on the knob and rotate to align the desired number with the alignment pin. To operate the 425DLX and 435 at higher than 60 psi, first release the excess pressure and then replace the adjustment piece with the optional plug (#4200215).

FILLING:

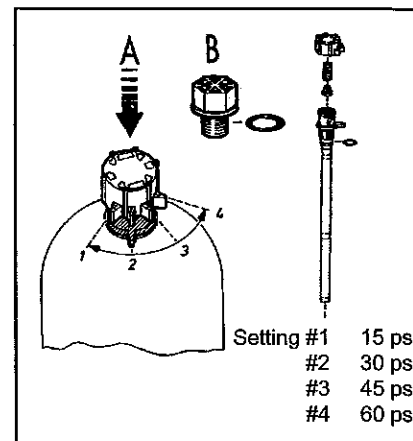

Mix the spray formula and the proper volume of water in a separate container. Pour the mix through the filter basket in the tank opening. This keeps debris from entering sprayer. Note: To fill the sprayer to its full 4 gallon capacity, set the pressure control valve to the 3 or 4 setting. (DELUXE MODELS ONLY) Add 2 or 3 gallons of spray formula mix. Pump the sprayer handle to prime the pump and fill the pressure cylinder. The volume of liquid in formula mix tank will appear to decrease as the pressure cylinder is filled. Liquid will flow through the top of the pressure regulator when the cylinder is completely full. Add the remaining formula mix to the tank. Remember that it's not necessary to completely fill the sprayer tank each time. Mix only the amount needed to get the job done.



Always read and follow manufacturer's instructions printed on the product label. This can save money and help prevent crop and environmental damage.

OPERATING FEATURES:

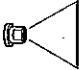
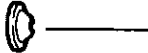
Nozzles - Your Solo sprayer is supplied with nozzle arrangements to provide a variety of spray patterns.

Item	Application	Part #
Flat spray nozzle 	Row treatment	4074263
Jet stream nozzle 	Spot & longer range	4074755
Jet stream nozzle and Swirl plate = hollow cone 	Shrubs and bushes	4074755 4074756
Plastic adjustable nozzle 	Spot, shrubs & bushes	4900527

SPRAY TIP ASSEMBLY

1. Flat spray nozzle
2. Filter
3. Jet cap
4. Swirl plate
5. Nozzle cap
6. Nozzle body
7. Brass adj. nozzle*
8. Nozzle retaining nut

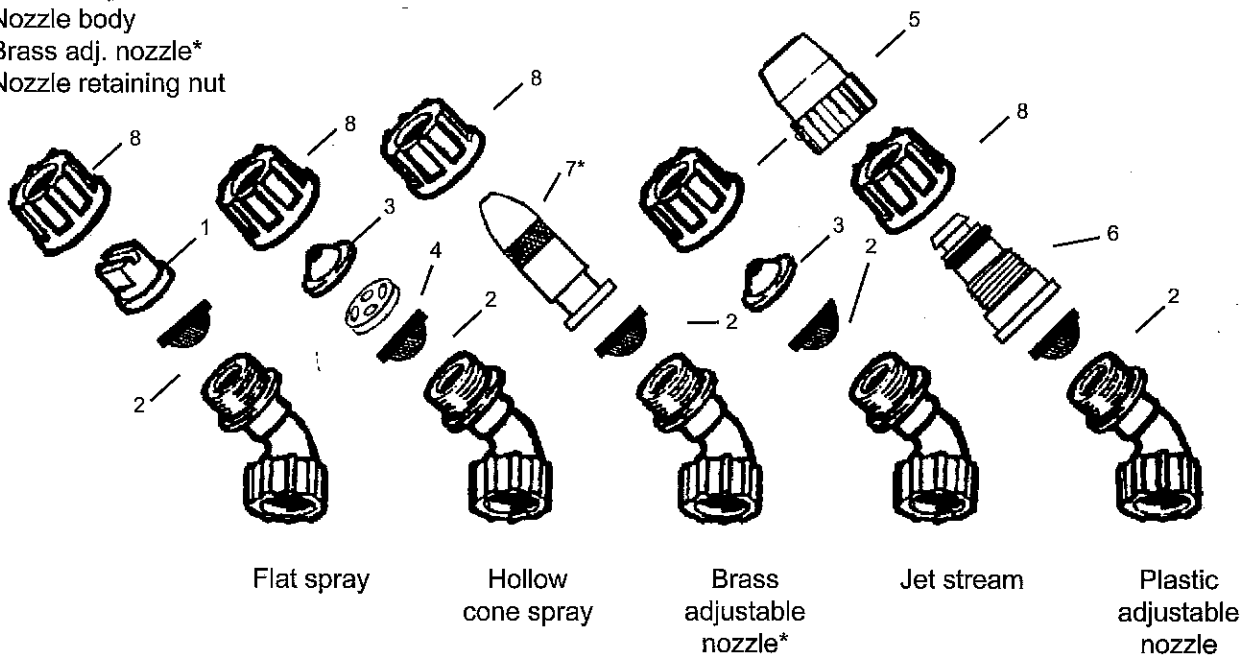

*Brass adjustable nozzle is not a standard item on all Solo sprayers.
Spray tips should be assembled as above for desired spray pattern.

SPRAYING:

Prime the pump with rapid pump strokes. When you feel very firm resistance, the pressure chamber is filling with liquid. With repeated piston strokes, the air in the pressure chamber is slowly compressed. By pressing the hand lever, the valve opens, and liquid is forced through the nozzle. The shut-off valve has a retaining clip which keeps the valve in the "OPEN" position for continuous operation. Pump using the end of the pump handle, as it is less fatiguing. The volume of liquid delivered varies with the working pressure which should be as high as needed to ensure an adequate spray pattern for each individual application.

NOTE: Should the pressure drop very quickly, drain the tank completely and pump without liquid. By this procedure, the air chamber is refilled with the required volume of air. It is advisable to pump the tank completely empty from time to time.

WETTABLE POWDERS:

Avoid use in piston pump sprayers models 425, 435, 473P! The Solo models 474, 475, 473D, 477 SW and 485 sprayers with a diaphragm pump are generally resistant to abrasive materials and are recommended for this purpose. Note: If you use a wettable powder in your 425, 435, 473P sprayer, be sure it is thoroughly mixed in the formula solution. Immediately after use, be sure to remove the piston, clean and lubricate the Viton® collar with Solo Superior Grease* or petroleum jelly. Thorough flushing of sprayer will extend the life of its working parts. If you use wettable powders in the piston pump sprayer, be sure to inspect regularly for seepage around the piston and repair accordingly.

CLEANING:

- After spraying, clean the tank thoroughly. If some spray liquid is left inside, drain tank completely.
- Pumping causes air to be taken in and the remaining liquid to be discharged. Pump until liquid and air are coming out through the nozzle.
- Refill tank with a few quarts of clean water and pump the water out as explained above (if necessary, repeat this procedure several times).
- If the shut-off valve is removed, the pump can be flushed quickly. Improper spray distribution is the result of a clogged nozzle, which is easily removed and cleaned.
- Soap and water may also be used to clean tank.
- Do not use aggressive cleaning agents or abrasives.
- Follow the recommendations of the chemical manufacturer for disposal of waste water and chemicals.
- Activated charcoal in liquid or other form may be used to absorb chemicals in tanks or spills.

NOTE: When cleaning the sprayer after working with hormone weedkillers, follow the instructions of the herbicide producers. Neutralize with activated charcoal. (Example: add 0.35 oz./1 g. of activated charcoal to 1.7 pint/1 liter of water and leave this detergent in the tank and the lines approximately for 24 hours.) This is very important if other chemicals should be sprayed as the residues of the herbicide may damage susceptible plants. Cleaning after application of products containing carbolineum, if they are not water soluble, should be done with a 5% soda lye having a temperature of 104°F (40°C). Rinse with plenty of clean water.

MAINTENANCE AND STORAGE TIPS:

To protect the piston, cylinder and Viton® collar, a fine mesh, stainless steel screen is located on the pressure cylinder inlet.

If you find that your sprayer will not empty the formula tank, check for a clogged inlet screen (2). The inlet screen is located at the bottom of the pressure cylinder on the side that faces your back.

One indication that it needs cleaning is that when you let go of the pump handle, it "springs" to the down position. The screen can be cleaned with a small bristle brush or a discarded toothbrush. See diagram for location of screen.

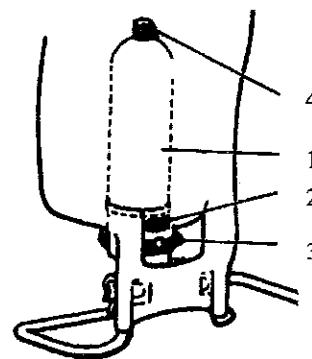

1. Pressure Cylinder
2. Inlet Screen
3. Cylinder Support
4. Pressure Control Valve (Deluxe Models Only)

- After operation, the sprayer should be stored away from direct sunlight to prevent UV damage.
- After removing the pump or when mounting a new Viton® collar, treat both the collar and the piston with water-resistant grease.*
- Before winter, drain all liquid in tank, lines and air chamber. (See "Cleaning.") Leave shut-off valve locked in the "open" position.
- For service, visit our website to locate your nearest Solo dealer. Always insist on original Solo spare parts.
- Regularly inspect hose, wand, pump, tank and shut-off valve for wear, damage or leaks. Repair promptly.
- Occasionally lubricate cap gasket.*

Avoid excessive wear by:

- 1) Regular lubrication of Viton® collar, cylinder and piston with water resistant grease.*
- 2) Prompt and thorough cleaning and flushing of sprayer. Soap and water work well.

*Use Solo Superior Grease (#9850). Petroleum jelly may also be used.

SOLO LIMITED WARRANTY

Solo Incorporated guarantees the original purchaser of Solo equipment that any failure of Solo manufactured parts due to defects in material and workmanship occurred during the applicable warranty period will be repaired or replaced without charge for parts or labor, except for those items not covered by warranty.

CONSUMER LIMITED WARRANTY: Solo equipment purchased for consumer use is covered by this Limited Warranty for a period of ONE (1) YEAR. Solo's polyethylene tank is covered by this limited warranty for the life of the unit.

COMMERCIAL LIMITED WARRANTY: Solo equipment purchased for commercial use is covered by this Limited Warranty for a period of ONE (1) YEAR.

OWNER'S OBLIGATION AND RESPONSIBILITY: Proof of purchase must be provided by the owner in order to obtain warranty service. Should any failure covered by this Limited Warranty occur, deliver or ship the Solo products or parts to an authorized Solo service center. Freight, packing and insurance costs, if any, will be borne by the owner. Follow normal maintenance service to include applicable lubrication, operation and storage of the product as explained in the operator's manual.

ITEMS NOT COVERED BY WARRANTY: Provisions of the Limited Warranty will not apply to the following: Any indirect or consequential damages that may result from the failure or malfunction of the Solo product. Normal service requirements arising during the warranty period, such as cleaning, normal wear, lubrication, filter, spray tips, etc. Normal service work over and above the repair or replacement of defective parts. Any failure that results from an accident, customer abuse, normal wear, neglect or failure to operate the product in accordance with the instructions provided in the operator's manual or provided with the product. When an alteration or modification has been performed on a Solo product, Solo is responsible only for products as originally furnished by Solo, provided the alterations or modifications do not adversely affect the product's operation, performance or durability. Parts or accessories that are incompatible with the product are not approved by Solo.

Full disclosure of Solo's Limited Warranty is available from your local Solo dealer or SOLO INCORPORATED, 5100 Chestnut Avenue, Newport News, Virginia 23605.

This Limited Warranty gives you specific legal rights and you may also have other rights, which vary from state to state.

ACCESSORIES:

The following accessories are not standard. Order them from your SOLO dealer.

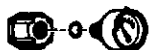

Pressure control gauge (#49 00 622): Displays spraying pressure so operator can maintain desired pressure level.



Brass adjustable spray nozzle (#06 10 410-P): Affords operator a full range of sprays from fine to jet stream. Standard on model 477 SW.



Drift guard (#49 00 430): Helps control application of formula under breezy conditions.



4-nozzle spray boom (#49 00 298): Mounted on the back part of the sprayer frame with 4 hollow cone jets for area treatment (total width 49-3/4"; distance between nozzles 16").

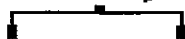

2-nozzle spray boom (#49 00 514): Handheld spray boom mounts on end of spray wand (total width 33"; distance between nozzles 24"). Includes 2 flat spray nozzles.



Twin nozzle (#49 00 477): This is a multi-purpose nozzle that attaches to the end of the spray wand for double row application.



4' to 8' Carbon Fiber Wand (49 00 445) This lightweight spray wand adjusts from 4' to 8' and replaces the standard spray tube to reach eaves or trees up to 25 ft. (7.6 meters).



60" Brass spray wand (#49 00 528): The spray wand is 60" (150 cm) long and replaces the standard spray tube for treating trees up to heights of 16 ft. (5 meters). Additional extension tube available in 20" length (#49-00 513).



Shoulder Saver Harness (#43 00 314): Heavy duty padded straps, padded lumbar support and fully adjustable straps.

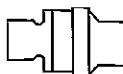

Solo Superior Grease (#9850): (4 oz.) Used in the manufacture of all Solo parts.

Controlled Flow Valve (CFValve™): Provides constant pressure and flow to the spray nozzle and can be used in various applications.

In the best interest of continued technological progress, we reserve the right to change design and configuration of any product without prior or other notice. Therefore, please note that text and illustrations of this manual are not to be considered binding and do not constitute a basis for legal or other claims.

NOTE: An order form is provided on pages 11 and 12.

SPARE PARTS LIST

Liste de pièces de rechange
Lista de piezas de recambio

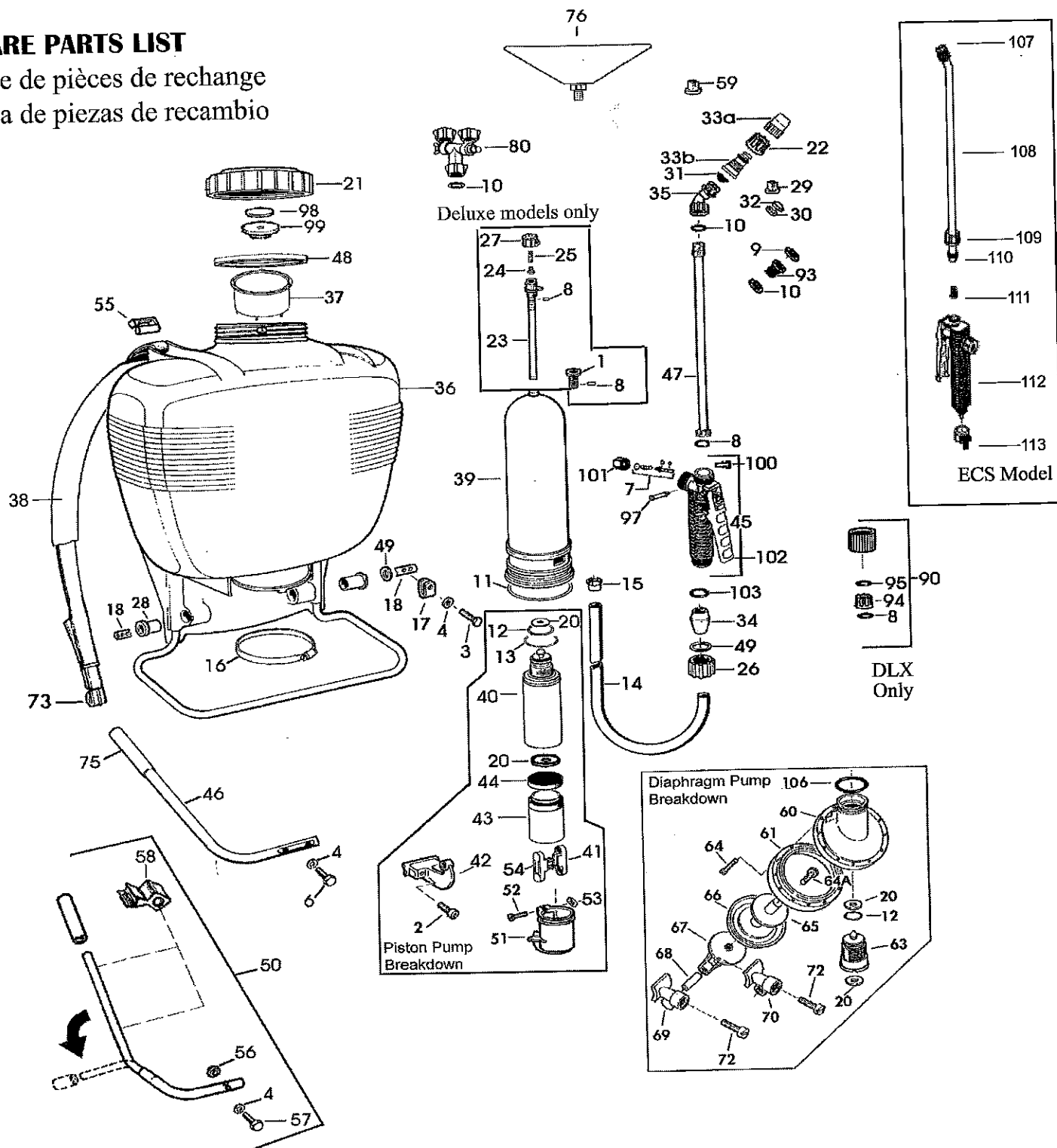

*Not standard on all models.

SPECIAL PARTS AND ACCESSORIES (Not shown in parts list)

Order No.	Description
4900310N	Conversion kit (from piston to diaphragm pump)
0610406-K	Diaphragm pump repair kit includes 8, 11-13, 20 (2 ea.), 24, 25, 66
0610407-K	Piston repair kit includes 10-13, 20 (2 ea.), 24, 25, 44
0610411-K	Wand repair kit includes 7-10, 22, 26, 34, 49, 103
0610409-K	Piston, rod & collar kit includes 41-44, 54
4400203	Pump assembly (Piston) includes 1, 8, 11, 12, 13, 20 (2 ea.), 39, 40, 41, 42, 43, 44, 54
4400221	Pump assembly (Diaphragm) includes 1, 8, 11, 12, 20 (2 ea.), 39, 61, 63, 64 (13 ea.), 65, 66, 67 (2ea.), 106

POS. #	ORDER #	FOR MOD.	DESCRIPTION	FRANCAIS	ESPAÑOL
2	00 10 165		Bolt	Vis T.C.	Tornillo cil.
3	00 12 185		Bolt **	Vis T.C.	Tornillo cil.
4	00 30 131		Washer **	Rondelle	Arandela
6	00 12 185		Bolt	Vis T.C.	Tornillo cil.
7	06 10 402-K		Shut-off valve repair kit	Pochette robinet d'arrêt	Juego rep. grifo de cierre
8	00 62 258		Gasket	Joint de connection	Junta de conexon
10	00 62 115		O-ring	Joint bague	Anillo O
11	00 62 291		O-ring	Joint bague	Anillo R
12	00 62 139		O-ring	Joint bague	Anillo R
13	00 62 140		O-ring	Joint bague	Anillo R
14	00 64 234		Hose 48" (item 26, 34, 49, 103 incl.)	Tuyau (Pos. 26, 34, 49, 103 incl.)	Manguera (artículo 26, 34, 49, 103 incl.)
15	00 66 388		Hose clamp	Collier cpl.	Abrazadera
16	00 66 394		Clamp	Collier cpl.	Abrazadera
17	40 43 123		Stop plate **	Butée	Pieza de apoyo
18	40 35 111		Pump shaft	Tuyau	Tubo
20	40 61 257		Valve plate	Joint de soupape	Placa de valvula
21	42 00 242		Red tank cap (item 48, 98 & 99 incl.)	Couvercle	Tapa del depósito (roja)
	42 00 305	Heavy Duty	Black tank cap (item 48, 98 & 99 incl.)	Couvercle	Tapa del depósito (negra)
22	40 74 148		Retaining nut	Ecrou de raccord	Tuerca de manguito
23	40 74 323		Valve body	Pièce de réglage	Pieza de ajuste
24	40 74 350		Sealing piece	Joint	Junta
25	00 70 260		Compression spring	Ressort de compression	Resorte de presion
26	40 74 337		Retaining nut	Ecrou de raccord	Tuerca de manguito
27	40 74 344		Control knob	Pièce de réglage	Tapa de ajuste
28	40 74 410		Bushing	Coussinet	Cohinete
29	40 74 263		Flat spray jet	Buse à diffusion large	Tobera de chorro ancho
30	40 74 756		Swirl plate	Pièce giratoire	Pieza de rayado
31	40 74 283		Jet filter	tamis de gicleur	Piltro de tobera
32	40 74 755		Jet cap	Capuchon de gicleur	Tapa de tobera
33	49 00 527		Plastic adjustable nozzle (Inc. a & b)	Buse réglable en plastique	Boquilla ajustable
34	40 74 500		Clamp	Pièce de serrage	Pieza de retencion
35	40 74 527		Elbow	Coude	Code
36	42 00 162	425, 474, 475, 476	Tank and frame assy., 4 gal.	Support de réservoir, 15l	Soporte de depósito, 15l
	42 00 293	435, 485	Tank and frame assy., 5 gal.	Support de réservoir, 20l	Soporte de depósito, 20l
	40 71 305	473P, 473D	Tank and frame assy., 3 gal.	Entonnoir	Embudo Filtro
37	42 00 166		Filter basket	Bretelle (Pos. 73 incl.)	Correaje (artículo 73 incl.)
38	43 00 315		Carrying strap (item 73 incl.)	Corps de pompe (pos. 10, 23-25, 27 incl.)	Camara de aire (artículo 10, 23-25, 27 incl.)
39	44 00 240		Pressure cylinder (Deluxe Models)	Cylindre cpl.	Cilindro mont
	4400240N		Pressure cylinder		
40	44 00 168		Cylinder, assy. (item 12, 13, 20 incl.)	Bielle sand taton	Biela
41	40 74 409		Connecting rod without stud	Levier	Palanca
42	40 74 262		Lever	Piston	Piston
43	40 73 558		Piston	Manchette Viton	Manguito Viton
44	44 00 189		Viton® collar	Robinet d'arrêt	Grifo de cierre, mont.
45	48 00 170		Shut-off valve, assy.	Levier de pompe (pos. 75 incl.)	Palanca de bomba (artículo 75 incl.)
46	48 00 17325		Pump lever (item 75 incl.)	Tuyau pulvérisateur (500 mm)	Tubo atomizador (500 mm)
47	49 00 230		Spray tube 20" (item 8, 26 incl.)	Joint bague (pos. 8, 26 incl.)	Anillo de junta (artículo 8, 26 included)
	49 00 645		Stainless Wand		
48	40 61 345		Gasket	Rondelle	Arandela
49	00 31 356		Washer	Coiffe protectrice	Tapa protectora
51	00 74 680		Protective cover	vis T.C.	Tronillo cil.
52	00 10 110		Bolt	Ecrou. hex.	Tuerca hex.
53	00 20 101		Hex. nut	Bielle avec teton	Biela
54	40 74 408		Connecting rod with stud	Porte-bretelle	Hebilla para correa
55	40 74 412		Buckle	Carter de membrane	Carter membrana
58	40 74 996		Wand retainer clip	Retenue de la lance	
60	40 73 411		Housing (diaphragm)	Joint bague	Anillo O
61	40 73 410		Flange	Siège soupape (pos. 12, 20 incl.)	Pieza rosada (artículo 12, 20 incl.)
63	44 00 222		Valve, assy. (item 12, 20 incl.)	Vis T.C.	Tornillo cil.
64	00 18 275		Screw	Plaque à membrane	Chapa de membrana
64A	00 18 427		Diaphragm screw	Vis de diaphragme	Tornillo de la diafragma
65	40 74 256		Plunger	Membrane	Membrana
66	40 74 245		Diaphragm	Bielle	Biela
67	40 74 255		Lever	Goujon	Perno
68	40 31 130		Wrist pin	Levier 1	Palanca 1
69	40 74 234		"R" connecting bracket	Levier 2	Palanca 2
70	40 74 243		"L" connecting bracket	Vis T.C.	Tornillo cil.
72	00 10 141		Bolt	Accroche	Gancho
73	40 74 832		Hook	Crochet	Gancho
74	49 00 252		Hollow cone jet nozzle (item 30, 32 incl.)	Buse à jet conique (pos. 30, 32 incl.)	Boquilla chorro de cono hueco
75	40 74 392		Grip	Poignée	Apretón
97	40 74 295		Pin	Goupille	Perno
98	40 61 464		Vent plate	Plaque de décompression	Placa de la respiradora
99	40 74 123		Vent cap	Capuchon de décompression	Tapa de la respiradora
100	40 74 329		Lock clip	Pince de verrouillage	Sujetador de cerradura
101	40 74 336		Retaining nut	Ecrou de serrage	Tuerca de retención
102	40 74 335		Lever	Levier	Palanca
103	00 62 271		O-ring	Joint torique	Anillo-O
106	00 62 324		O-ring	Joint torique	Anillo-O
107	49 00 527		Adjustable nozzle	Buse réglable	Boquilla ajustable
108	49 00 104		Wand	Lance	Vara
109	40 74 148		Retaining nut		Tuerca de manguito
110	00 62 110		O-ring	Joint torique	Anillo-O
111	40 74 284		Handle filter		
112	48 00 107		Shut-off valve	Dispositif d'activation	Válvula de cierre
113	40 74 654N		Hose barb		
**			Diaphragm Pump Sprayer Only		

ACCESSORIES

1	42 00 215		Plug (item 8 incl.)	Bouchon (pos. 8 incl.)	Tapón (artículo 8 incl.)
9	00 62 106		O-ring	Joint torique	Anillo-O
	49 00 319		Spray wand 27" (690 mm) (item 8, 26 incl.)	Lance de vaporisation de 69 cm (27 po) 18, 26 incl.)	Vara de pulverizador 27" (690mm) (art. 8, 26 incl.)
50	49 00 454		Fold-away handle (item 4, 56, 57, 58 incl.)	Poignée rabattable (réf. 4, 56, 57, 58 compr.)	Manilla pliegue (artículo 4, 56, 57, 58 incl.)
56	00 20 119		Nut	Ecrou	Tuerca
57	00 12 192		Bolt	Boulon	Cerjo
58	40 74 996		Clip	Pince	Sujetador
59	00 65 210	Heavy Duty	Brass flat spray nozzle	Buse à jet plat en laiton	Boquilla de pulverizador de latón plano
76	49 00 430		Drift guard	Anti-dérive	Protector de la deriva
80	49 00 477		Double spray nozzle	Buse à double jet	Boquilla doble de pulverizador
	49 00 528	Heavy Duty	Extension wand 60" (1250 mm)	Rallonge de lance de 1,25m (60 po)	Vara de extensión (1250 mm)
90	49 00 622		Pressure gauge w/connection parts		Mandometro
	49 00 513	Heavy Duty	Extension tube 20" (500 mm)	Clapet anti-retour	Tuba alargador (500 mm)
93	27 00 316		No drip check valve		Valvula de retencion
94	40 74 338		Retaining nut	Joint torique	Tuerca de manguito
95	00 62 249		O-ring	Joint bague	Anillo O
	06 10 410-P		Adj. spray nozzle assy.	Bouchier	Tobera de allura, mont.
	49 00 207		Adj. spray nozzle	Buse longue protee, cpl.	
	43 00 314		Shoulder saver harness	Reducteur avec joints	Empaquetaduras
	42 00 205		Reduction insert, gaskets incl.	Pochette joints (10, 22, 31, 33, 35 incl.)	Juego empaquetaduras (10, 22, 31, 33, 35 incl.)
	49 00 258N		Elbow nozzle assy. (item 10, 22, 31, 33, 35 incl.)		
	4800182		Pressure Regulating Valve (Items 8, 23, 24, 25, 27)		